

Specifications

Nominal Voltage		12V
Rated Capacity(10 hour rate)		120AH
Dimension	Total Height (with terminals)	234mm(9. 21inches)
	Height	211mm(8. 31inches)
	Length	408mm(16. 06inches)
	Width	172mm(6. 77inches)
Weight		Approx.33kg(72. 69lbs)

Characteristics

Capacity 77°F(25°C)	120 hour rate (1. 2A)	144AH
	20 hour rate (6. 6A)	132AH
	10 hour rate (12A)	120AH
Internal Resistance	Full charged Battery 77°F(25°C)	6mΩ
Self - Discharge 77°F(25°C)	Capacity after 3 month storage	95%
	Capacity after 6 month storage	85%
	Capacity after 12 month storage	80%
Max. Discharge Current 77°F(25°C)	1000A(5S)	
Terminal	Standard	F4
	Optional	
Charging (Constant Voltage)	Cycle	Initial Charging Current 36A or small 14.4V~14.8V/77°F(25°C)
	Float	13.5V~13.8V/77°F(25°C)

Terminal (F4)

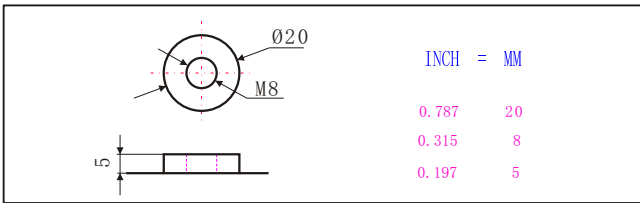

Charge characteristics 77°F(25°C)

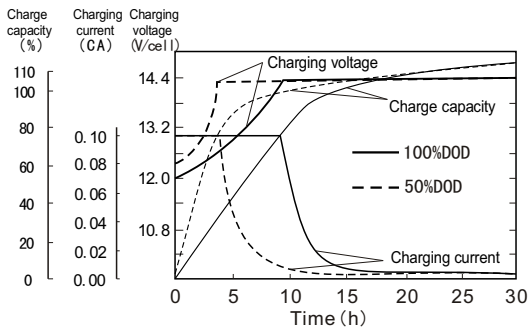

Discharge characteristics 77°F(25°C)

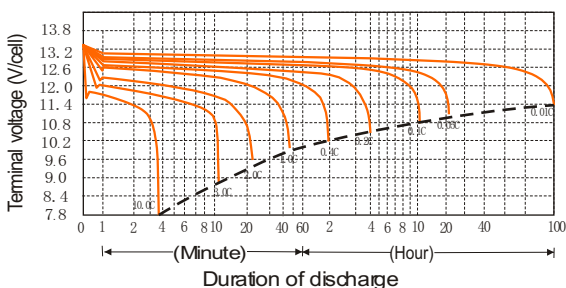

Discharge current and final discharge voltage

Discharge current (A)	Final discharge voltage (V/cell)
0. 05C or below or intermittent discharge	11. 4
0. 05C of current close to it	11. 1
0. 1C of current close to it	10. 8
0. 2C of current close to it	10. 5
From 0. 2C to 0. 5C	10. 2
From 0. 5C to 1C	9. 6
From 1C to 3C	9. 0
Current in excess of 3C	7. 8

Temperature and float service life

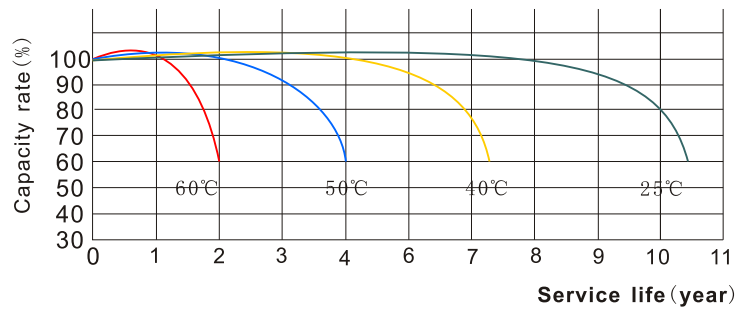

Temperature and discharge capacity

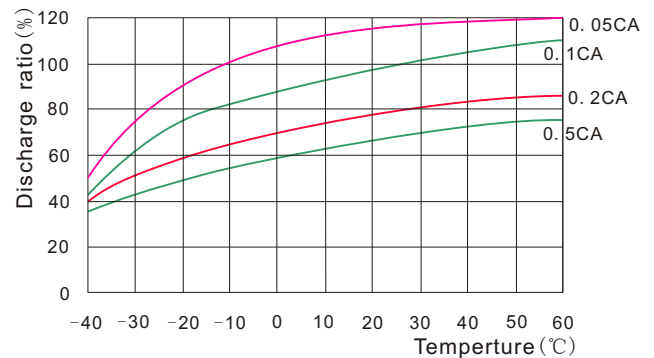

Cycle life curves (25°C)

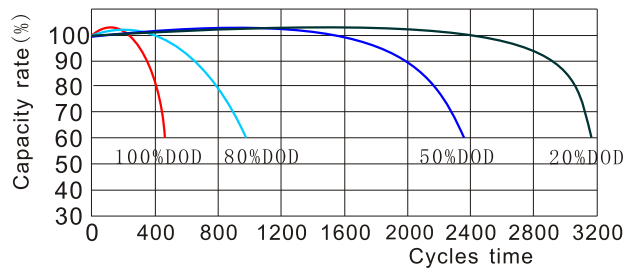

Float service life

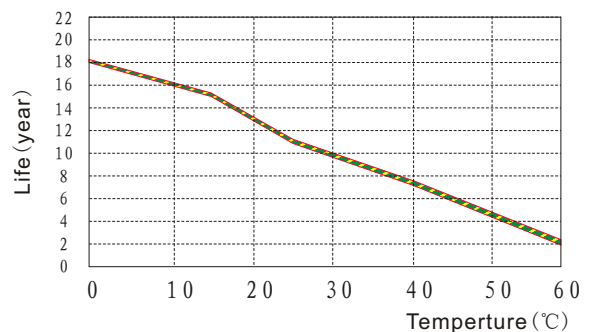

Constant Current Discharge Characteristics Units: Amperes (25°C, 77°F)

End voltage per cell	5min	15min	30min	45min	1h	2h	3h	4h	5h	6h	8h	10h	12h	20h	24h
1.60V	324	207	136	103	83.9	50.0	36.4	28.3	24.0	20.6	15.6	12.6	10.6	6.64	5.56
1.67V	279	188	126	97.2	81.2	47.8	34.6	28.0	22.8	20.4	15.4	12.4	10.6	6.64	5.56
1.70V	267	182	122	96.0	78.5	47.0	33.8	27.7	22.7	20.3	15.2	12.2	10.6	6.62	5.54
1.75V	242	170	118	92.3	76.0	45.2	32.9	27.0	22.0	19.8	15.0	12.1	10.5	6.62	5.53
1.80V	214	156	113	88.9	72.7	43.7	32.4	26.5	21.5	19.3	14.6	12.0	10.3	6.60	5.51
1.83V	187	142	105	82.6	68.8	41.8	31.2	25.4	20.5	18.6	14.2	11.6	10.0	6.58	5.35
1.85V	160	129	96.0	76.4	64.9	40.0	30.0	24.5	19.7	18.0	13.7	11.3	9.73	6.56	5.20

Discharge Data with Constant Power Units: Watts per cell (25°C, 77°F)

End voltage per cell	5min	15min	30min	45min	1h	2h	3h	4h	5h	6h	8h	10h	12h	20h	24h
1.60V	539	362	248	189	156	95.5	69.6	54.1	46.1	40.4	30.6	24.9	20.9	13.0	10.9
1.67V	486	338	232	181	152	92.5	67.9	53.9	44.6	40.0	30.0	24.4	20.9	13.0	10.9
1.70V	465	329	226	179	148	90.1	65.2	53.5	43.8	39.7	29.9	24.1	20.9	13.0	10.9
1.75V	429	309	218	173	144	87.1	63.6	52.7	42.7	39.1	29.3	23.9	20.9	13.0	10.8
1.80V	389	285	211	168	139	84.2	62.9	51.7	41.6	38.5	28.8	23.6	20.3	12.8	10.8
1.83V	344	264	197	157	132	81.1	60.7	50.0	40.2	37.4	27.8	23.0	19.8	12.8	10.5
1.85V	298	243	183	147	125	78.0	58.6	48.2	38.6	36.4	26.9	22.4	19.3	12.7	10.3