

Discharge current and final discharge voltage

Discharge current (A)	Final discharge voltage (V/cell)
0.05C or below or intermittent discharge	11.4
0.05C of current close to it	11.1
0.1C of current close to it	10.8
0.2C of current close to it	10.5
From 0.2C to 0.5C	10.2
From 0.5C to 1C	9.6
From 1C to 3C	9.0
Current in excess of 3C	7.8

Specifications

Nominal Voltage		12V
Rated Capacity(10 hour rate)		70AH
Dimension	Total Height (with terminals)	210mm(8.27inches)
	Height	206mm(8.11inches)
	Length	259mm(10.2inches)
	Width	169mm(6.65inches)
Weight		Approx.23kg(50.66lbs)

Characteristics

Capacity 77°F(25°C)	120 hour rate (0.7A)	84AH
	20 hour rate (3.9A)	78AH
	10 hour rate (7A)	70AH
Internal Resistance	Full charged Battery 77°F(25°C)	7mΩ
	Self - Discharge 77°F(25°C)	
Capacity after 3 month storage		95%
Capacity after 6 month storage		85%
Capacity after 12 month storage		80%
Max. Discharge Current 77°F(25°C)		700A(5S)
Terminal	Standard	F3
	Optional	
Charging (Constant Voltage)	Cycle	Initial Charging Current 21A or small 14.4V~14.8V/77°F(25°C)
	Float	13.5V~13.8V/77°F(25°C)

Temperature and float service life

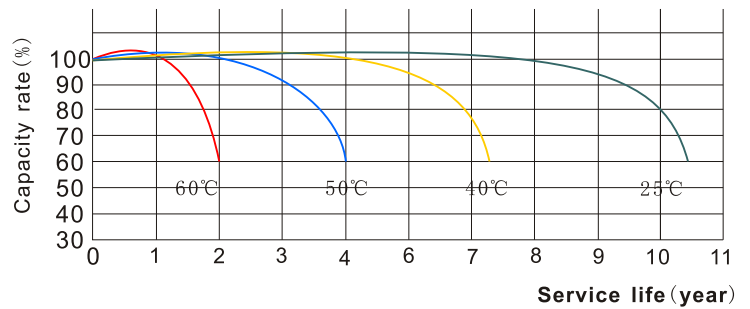

Temperature and discharge capacity

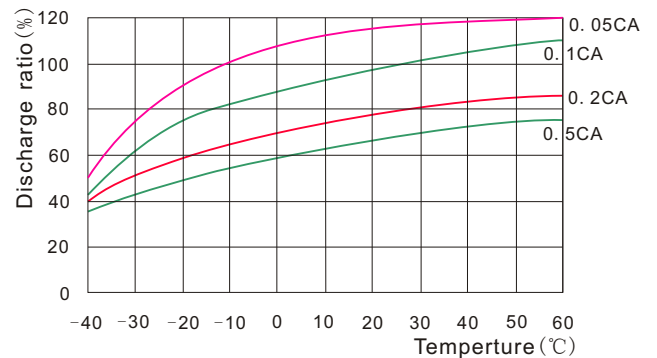

Terminal (F3)

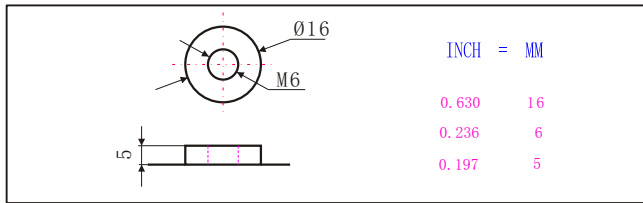

Charge characteristics 77°F(25°C)

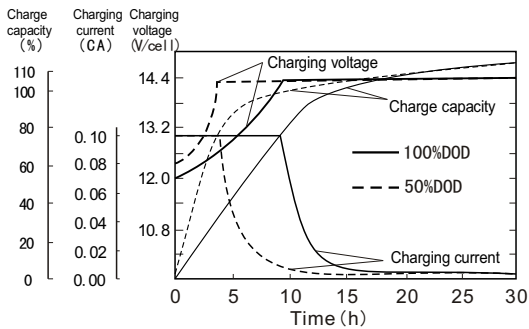

Discharge characteristics 77°F(25°C)

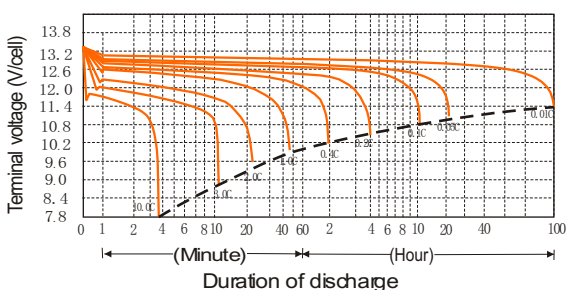

Cycle life curves (25°C)

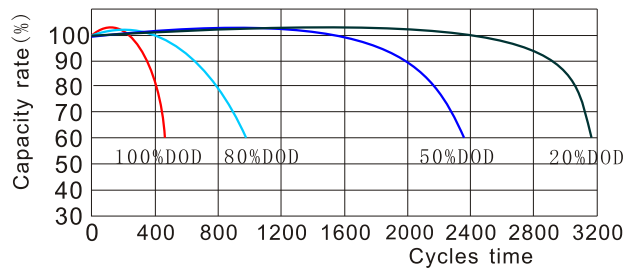

Float service life

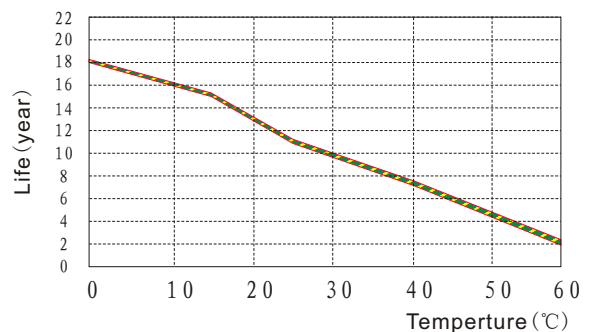

Constant Current Discharge Characteristics Units: Amperes (25°C, 77°F)

End voltage per cell	5min	15min	30min	45min	1h	2h	3h	4h	5h	6h	8h	10h	12h	20h	24h
1.60V	189	121	79.5	59.9	48.9	29.2	21.2	16.5	14.0	12.0	9.10	7.35	6.20	3.87	3.24
1.67V	163	109	73.7	56.7	47.4	27.9	20.2	16.3	13.3	11.9	8.96	7.21	6.20	3.87	3.24
1.70V	156	106	71.4	56.0	45.8	27.4	19.4	16.2	13.2	11.8	8.89	7.14	6.20	3.86	3.23
1.75V	142	99.3	68.6	53.8	44.3	26.4	19.2	15.8	12.8	11.6	8.75	7.04	6.14	3.86	3.23
1.80V	125	90.9	66.0	51.9	42.4	25.5	18.9	15.5	12.5	11.3	8.54	7.00	6.01	3.85	3.21
1.83V	109	83.1	61.0	48.2	40.1	24.4	18.2	14.8	12.0	10.8	8.26	6.79	5.84	3.84	3.12
1.85V	93.3	75.2	56.0	44.6	37.9	23.3	17.5	14.3	11.5	10.5	7.98	6.06	5.68	3.83	3.03

Discharge Data with Constant Power Units: Watts per cell (25°C, 77°F)

End voltage per cell	5min	15min	30min	45min	1h	2h	3h	4h	5h	6h	8h	10h	12h	20h	24h
1.60V	314	211	144	110	91.3	55.7	40.6	31.6	26.9	23.6	17.8	14.5	12.2	7.56	6.34
1.67V	280	197	135	105	89.9	54.0	39.6	31.4	26.0	23.3	17.5	14.2	12.2	7.56	6.34
1.70V	271	192	132	104	86.4	52.6	38.0	31.2	25.6	23.2	17.4	14.1	12.2	7.56	6.34
1.75V	250	180	127	101	84.0	50.8	37.1	30.7	24.9	22.8	17.0	13.9	12.2	7.56	6.33
1.80V	227	166	123	97.9	80.8	49.1	36.7	30.2	24.3	22.4	16.8	13.8	11.8	7.49	6.31
1.83V	200	154	115	91.7	76.8	47.3	35.4	29.2	23.4	21.8	16.2	13.4	11.6	7.49	6.14
1.85V	174	142	107	85.5	72.8	45.5	34.2	28.1	22.5	21.2	15.7	13.1	11.3	7.42	6.00